

AB2 Series - Two-Way Forged Body Threaded

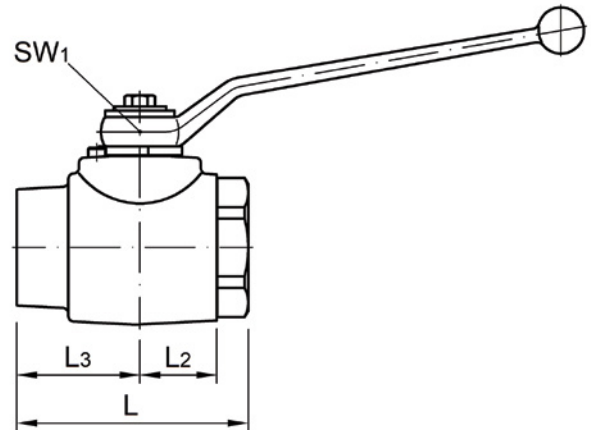

- Carbon steel with zinc nickel plating
- Duplex/316 stainless steel available from stock
- POM seats and Buna O-rings standard on carbon steel valves (-11DB)
- POM seats and Viton O-rings standard on stainless steel valves (-22DV)
- Handle shown in Handle Code field supplied standard
- Dimensions in inches unless otherwise noted
- Dimensions subject to change without notice

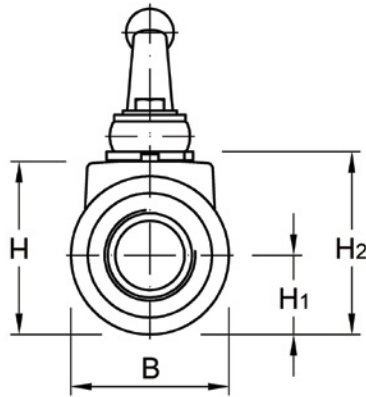

AB2 SERIES NPT/SAE

NPT PART NUMBER	SAE PART NUMBER	DN (NOMINAL SIZE IN MM)	NPT THREAD	SAE THREAD	L	L2	L3	B	H	H1	H2	SW1	HANDLE CODE CC/SS (SEE PG 50-51)	WEIGHT (LBS)	PSI MAX	LOCKING KIT # (SEE PG 48-49)
AB2N1-1/4	AB2S#20	32	1-1/4-11.5	1-5/8 - 12UN-2B	4.33	1.44	2.30	2.87	3.15	1.44	3.33	0.67	21/37	5.7	6090	LK32/40/50
AB2N1-1/2	AB2S#24	40	1-1/2-11.5	1-7/8 - 12UN-2B	4.49	1.57	2.24	3.35	3.54	1.67	3.72	0.67	21/37	9.6	6090	LK32/40/50
AB2N2	AB2S#32	50	2-11.5	2½ - 12UN-2B	5.08	1.89	2.56	3.90	4.09	1.95	4.27	0.67	22/38	12.2	6090	LK32/40/50



AB2 Series - Two-Way Forged Body Threaded

Model Code Breakdown

AB2 N2 - 1 1 D B _

VALVE SERIES

CONNECTION TYPE/SIZE

N	NPT Pipe Thread
S	SAE Straight Thread
B	BSPP Thread

BODY & ADAPTER MATERIAL

1	Carbon Steel
2	Duplex/ 316 Stainless Steel

BALL & STEM MATERIAL

1	Carbon Steel
2	316 Stainless Steel

**LOCKING KIT OR
OPTIONAL HANDLE CODE**
(See pages 48-51)

ADAPTER & STEM SEALS

B	Buna
V	Viton

BALL & STEM SEATS

D	POM
---	-----

Please consult your system's seal manufacturer for recommendation of seal selection, as Anchor Fluid Power does not accept responsibility for seal selection.

MAXIMUM & MINIMUM WORKING TEMPERATURES FOR SEAL MATERIALS

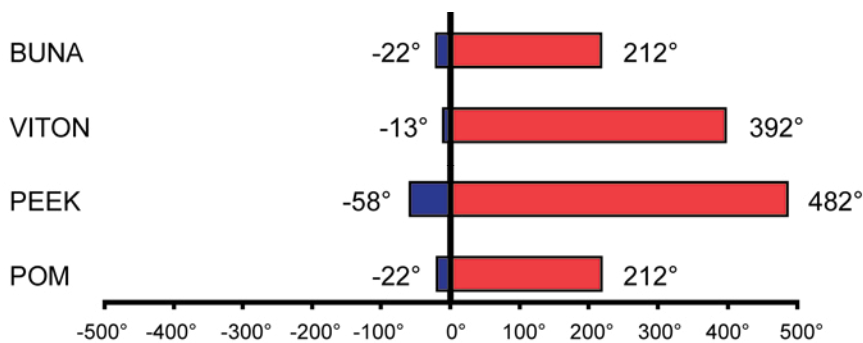

All temperatures are in degrees Fahrenheit.