

AES Series - Two-Way Block Body Flange Head

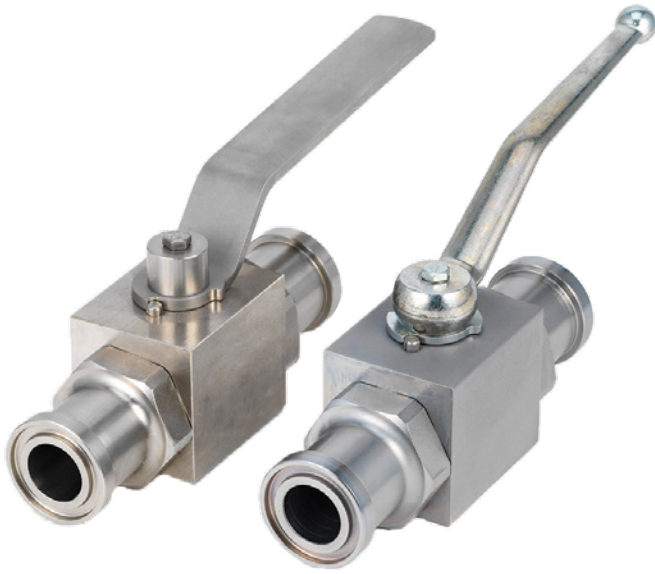

- O-ring groove both ends
- Carbon steel with zinc nickel plating
- 316 stainless steel available from stock
- POM seats and Buna O-rings standard on carbon steel valves (-11DB)
- POM seats and Viton O-rings standard on stainless steel valves (-22DV)
- Handle shown in Handle Code field supplied standard
- Dimensions in inches unless otherwise noted
- Dimensions subject to change without notice

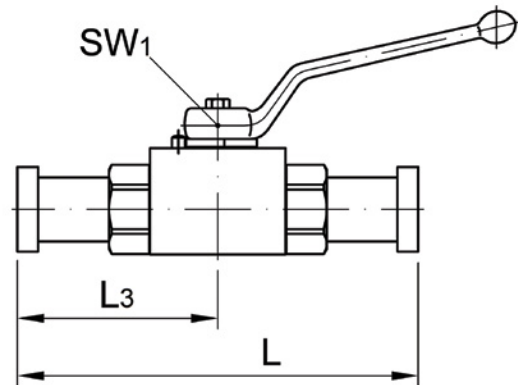
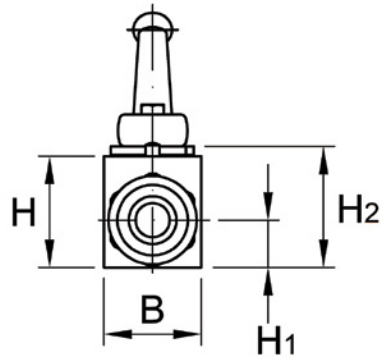

AES SERIES CODE 61/CODE 62

CODE 61 PART NUMBER	CODE 62 PART NUMBER	DN (NOMINAL SIZE IN MM)	FLANGE SIZE	L	L3	B	H	H1	H2	SW1	HANDLE CODE CC/SS (SEE PG 50-51)	WEIGHT (LBS)	PSI MAX	LOCKING KIT # (SEE PG 48-49)
AES3#8	AES6#8	13	1/2	5.94	2.97	1.38	1.57	0.67	1.71	0.39	14/34	2.2	5075/6090	LK12
AES3#12	AES6#12	19	3/4	6.38/6.85	3.19/3.43	1.77	2.17	0.94	2.32	0.55	15/35	4.0	5075/6090	LK20/25
AES3#16	AES6#16	25	1	7.01/7.80	3.50/3.90	2.17	2.36	1.02	2.52	0.55	15/35	5.7	4640/6090	LK20/25



AES Series - Two-Way Block Body Flange Head

Model Code Breakdown

AES3 #16 - 1 1 D B _

VALVE SERIES

AES3	Code 61
AES6	Code 62

CONNECTION SIZE

BODY & ADAPTER MATERIAL

1	Carbon Steel
2	316 Stainless Steel

BALL & STEM MATERIAL

1	Carbon Steel
2	Duplex/ 316 Stainless Steel

**LOCKING KIT OR
OPTIONAL HANDLE CODE**
(See pages 48-51)

ADAPTER & STEM SEALS

B	Buna
V	Viton

BALL & STEM SEATS

D	POM
---	-----

Please consult your system's seal manufacturer for recommendation of seal selection, as Anchor Fluid Power does not accept responsibility for seal selection.

MAXIMUM & MINIMUM WORKING TEMPERATURES FOR SEAL MATERIALS

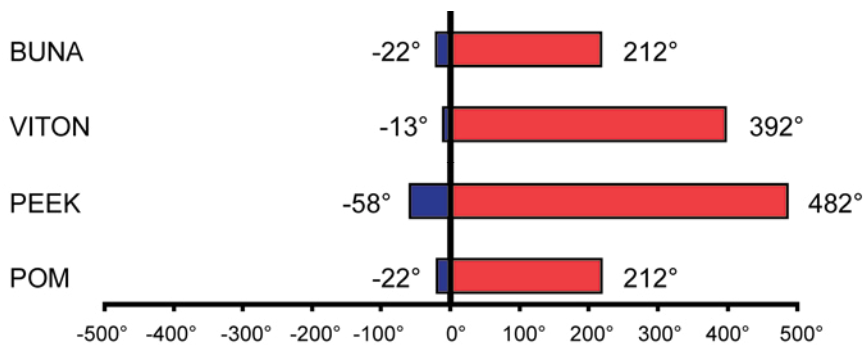

All temperatures are in degrees Fahrenheit.