

## SAE Thread to Tank Coupling

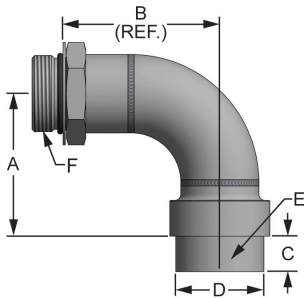

- Suction to 400 psi max
- Buna seals standard / Viton optional
- Carbon steel natural finish
- 90° & 45° SAE thread with adjustable nut
- Material certificates available upon request
- SAE threads manufactured to J1926



90° SAE THREAD TO TANK COUPLING										
	LINE SIZE	TANK PILOT	A	B (REF.)	C	D	E (INTERNAL THREAD)	F	ID	BALL VALVE
20NPT-20SAE90	1.25	1.25	3.01	3.28	0.75	1.88	1 1/4-11.5	1 5/8-12	1.08	LV2BS#20-2T-MH
*24NPT-24SAE90	1.50	1.50	3.38	3.65	0.75	2.13	1 1/2-11.5	1 7/8-12	1.32	LV2BS#24-2T-MH
*32NPT-32SAE90	2.00	2.00	4.13	4.40	0.88	2.63	2-11.5	2 1/2-12	1.58	LV2BS#32-2T-MH
*40NPT-40SAE90	2.50	2.50	5.38	5.23	1.00	3.25	2 1/2-8	3-12	2.09	LV2BS#40-2T-MH
*48NPT-48SAE90	3.00	3.00	6.00	6.15	1.00	4.00	3-8	3 1/2-12	2.48	LV2BS#48-2T-MH
*64NPT-64SAE90	4.00	4.00	8.00	7.65	1.00	5.00	4-8	4 1/2-12	3.94	LV2BS#64-2T-MH

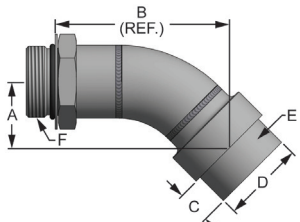

45° SAE THREAD TO TANK COUPLING										
	LINE SIZE	TANK PILOT	A	B (REF.)	C	D	E (INTERNAL THREAD)	F	ID	BALL VALVE
20NPT-20SAE45	1.25	1.25	1.51	3.96	0.75	1.88	1 1/4-11.5	1 5/8-12	1.08	LV2BS#20-2T-MH
*24NPT-24SAE45	1.50	1.50	1.60	4.17	0.75	2.13	1 1/2-11.5	1 7/8-12	1.32	LV2BS#24-2T-MH
*32NPT-32SAE45	2.00	2.00	1.77	4.60	0.88	2.63	2-11.5	2 1/2-12	1.58	LV2BS#32-2T-MH
*40NPT-40SAE45	2.50	2.50	2.39	5.68	1.00	3.25	2 1/2-8	3-12	2.09	LV2BS#40-2T-MH
*48NPT-48SAE45	3.00	3.00	2.48	6.18	1.00	4.00	3-8	3 1/2-12	2.48	LV2BS#48-2T-MH
*64NPT-64SAE45	4.00	4.00	3.18	7.39	1.00	5.00	4-8	4 1/2-12	3.94	LV2BS#64-2T-MH

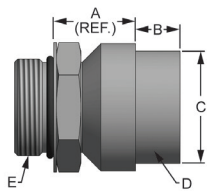

STRAIGHT SAE THREAD TO TANK COUPLING										
	LINE SIZE	TANK PILOT	A (REF.)	B	C	D (INTERNAL THREAD)	E	ID	BALL VALVE	
20NPT-20SAE	1.25	1.25	1.38	0.75	1.88	1 1/4-11.5	1 5/8-12	1.08	LV2BS#20-2T-MH	
*24NPT-24SAE	1.50	1.50	1.51	0.75	2.13	1 1/2-11.5	1 7/8-12	1.32	LV2BS#24-2T-MH	
*32NPT-32SAE	2.00	2.00	1.51	0.88	2.63	2-11.5	2 1/2-12	1.58	LV2BS#32-2T-MH	
*40NPT-40SAE	2.50	2.50	1.58	1.00	3.25	2 1/2-8	3-12	2.09	LV2BS#40-2T-MH	
*48NPT-48SAE	3.00	3.00	1.65	1.00	4.00	3-8	3 1/2-12	2.48	LV2BS#48-2T-MH	
*64NPT-64SAE	4.00	4.00	1.65	1.00	5.00	4-8	4 1/2-12	3.94	LV2BS#64-2T-MH	

\* Uses Adjustable Spanner  
 † Optional Ball Valve sold separately

