

# AB2 Series - Two-Way Round Body Threaded

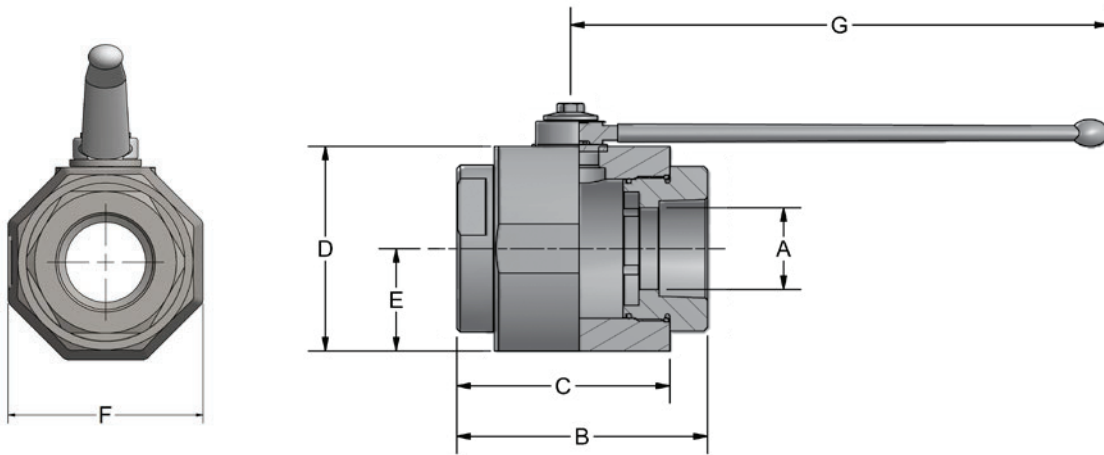

- Carbon Steel with Zinc Chromate Plating (RoHS Compliant)
- 316 stainless steel available from stock
- Unrestricted bore available through 2" size
- POM seats & Buna O-rings standard on carbon steel valves
- Optional seal materials available for extreme temperature applications & fluid compatibility (Consult Factory)



Standard handle supplied is C81302BSW17. Refer to page 45 for details.

AB2 SERIES FULL BORE										
NPT	SAE	PSI MAX	A BORE	B	C	D	E	F	G	WEIGHT
AB2 N1-1/4	AB2 S#20	6090	1.26	4.53	2.95	3.50	1.67	3.35	12.20	9.60 LBS
AB2 N1-1/2	AB2 S#24	6090	1.57	5.16	3.35	4.17	2.07	4.13	12.20	14.95 LBS
AB2 N2	AB2 S#32	6090	1.89	5.51	3.95	4.55	2.30	4.61	12.20	18.11 LBS

NPT threads in accordance with ANSI B.1.20.1 specifications.  
 SAE threads in accordance with SAE J1926-1 specifications.



# AB2 Series - Two-Way Round Body Threaded

## Model Code Breakdown

AB2 N1 1/2 \_ - 1 1 D B \_

**VALVE SERIES**

**CONNECTION TYPE/SIZE**

N	NPT Pipe Thread
S	SAE Straight Thread
B	BSPP Thread

**BORE RESTRICTION**

blank	Unrestricted Bore
R	Restricted Bore

**BODY & ADAPTER MATERIAL**

1	Carbon Steel
2	316 Stainless Steel

**BALL & STEM MATERIAL**

1	Carbon Steel
2	316 Stainless Steel

**LOCKING KIT OR  
OPTIONAL HANDLE CODE**  
(See pages 44 & 45)

**ADAPTER & STEM SEALS**

B	Buna- Standard
V	Viton (Std on S/S)

**BALL & STEM SEATS**

D	POM- Standard
P	PEEK

Please consult your system's seal manufacturer for recommendation of seal selection, as Anchor Fluid Power does not accept responsibility for seal selection.

**MAXIMUM & MINIMUM WORKING TEMPERATURES FOR SEAL MATERIALS**

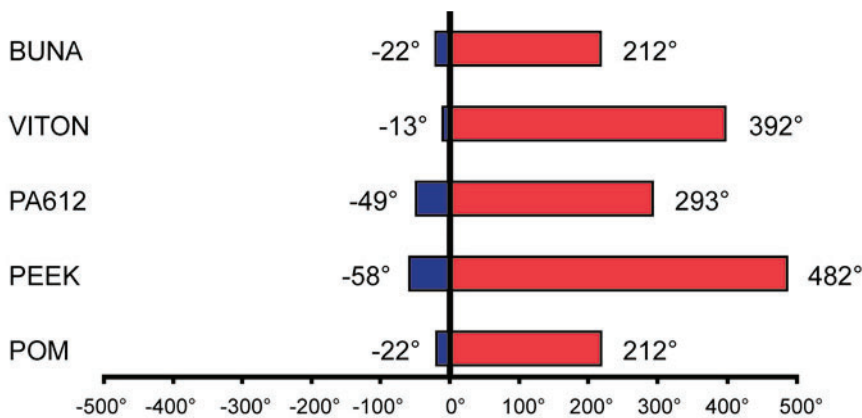

All temperatures are in degrees Fahrenheit.