

ARS Series - Two-Way Direct Mount

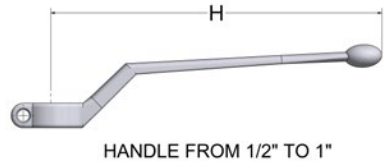

- Carbon Steel with Zinc Chromate Plating (RoHS Compliant)
- 316 stainless steel available
- POM seats & Buna O-rings standard on carbon steel valves

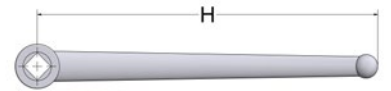
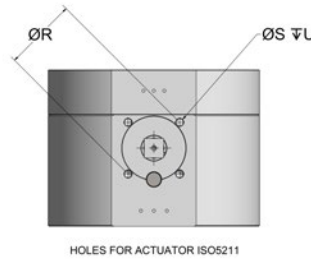
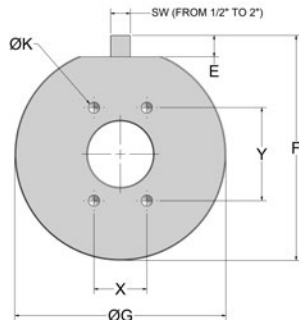
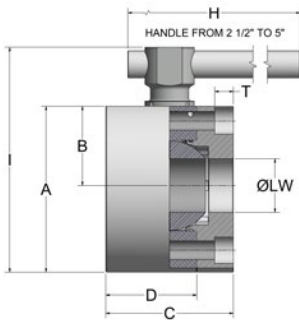

ARS3 SERIES CODE 61

SERIES	SIZE	PSI MAX	A	B	C	D	E	F	G	H	I	Y	X	K	R	S	T	U	SW	LW	WEIGHT
ARS3#8	1/2"	3000	2.64	1.10	2.95	2.28	0.43	3.08	3.07	4.33	3.09	1.50	0.69	5/16"-18	1.42	M5	0.71	0.39	0.35	0.51	5.3 LBS
ARS3#12	3/4"	3000	3.37	1.44	3.15	2.36	0.55	3.94	4.06	7.09	4.06	1.87	0.87	3/8"-16	1.97	M6	0.71	0.39	0.55	0.79	8.6 LBS
ARS3#16	1"	3000	3.88	1.56	3.46	2.72	0.55	4.45	4.65	7.09	5.75	2.06	1.03	3/8"-16	1.97	M6	0.75	0.39	0.55	0.98	13.9 LBS
ARS3#20	1-1/4"	3000	5.65	2.79	3.94	2.87	0.55	6.38	5.71	11.81	6.73	2.31	1.19	7/16"-14	1.97	M6	0.79	0.39	0.67	1.26	27.0 LBS
ARS3#24	1-1/2"	3000	6.30	3.07	4.33	3.15	0.55	7.03	6.50	11.81	7.38	2.75	1.41	1/2"-13	1.97	M6	0.79	0.39	0.67	1.50	37.2 LBS
ARS3#32	2"	3000	7.56	3.66	4.57	3.54	0.55	8.09	7.72	11.81	8.44	3.06	1.69	1/2"-13	2.76	M8	0.79	0.39	0.67	1.89	56.5 LBS
ARS3#40	2-1/2"	2500	7.80	3.66	5.91	4.21	0.81	8.35	7.99	23.62	10.24	3.50	2.00	1/2"-13	2.76	M8	0.79	0.51	0.75	2.48	72.1 LBS
ARS3#48	3"	2300	8.07	3.94	5.91	4.21	0.87	8.96	8.27	23.62	10.98	4.19	2.44	5/8"-11	2.76	M8	0.94	0.51	0.75	2.87	80.3 LBS
ARS3#64	4"	500	9.88	4.80	6.69	5.20	1.06	10.94	10.16	23.62	12.80	5.13	3.07	5/8"-11	4.02	M10	0.94	0.51	0.94	3.74	135.1 LBS
ARS3#80	5"	500	11.34	5.51	8.27	6.30	1.38	12.68	12.20	23.62	14.67	6.00	3.63	5/8"-11	4.92	M12	1.18	0.67	1.42	4.53	216.2 LBS

ARS3 SERIES CODE 62

SERIES	SIZE	PSI MAX	A	B	C	D	E	F	G	H	I	Y	X	K	R	S	T	U	SW	LW	WEIGHT
ARS6#8	1/2"	6000	2.64	1.10	2.95	2.28	0.43	3.08	3.07	4.33	3.09	1.59	0.72	5/16"-18	1.42	M5	0.71	0.39	0.35	0.51	11.7 LBS
ARS6#12	3/4"	6000	3.37	1.44	3.15	2.36	0.55	3.94	4.06	7.09	4.06	2.00	0.94	3/8"-16	1.97	M6	0.71	0.39	0.55	0.79	19.0 LBS
ARS6#16	1"	6000	3.88	1.56	3.46	2.72	0.55	4.45	4.65	7.09	5.75	2.25	1.09	7/16"-14	1.97	M6	0.75	0.39	0.55	0.98	30.7 LBS
ARS6#20	1-1/4"	6000	5.65	2.79	3.94	2.87	0.55	6.38	5.71	11.81	6.73	2.63	1.25	1/2"-13	1.97	M6	0.87	0.39	0.67	1.26	59.4 LBS
ARS6#24	1-1/2"	6000	6.30	3.07	4.33	3.15	0.55	7.03	6.50	11.81	7.38	3.13	1.44	5/8"-11	1.97	M6	0.87	0.39	0.67	1.50	82.0 LBS
ARS6#32	2"	6000	7.56	3.66	4.57	3.54	0.55	8.09	7.72	11.81	8.44	3.81	1.75	3/4"-10	2.76	M8	1.10	0.39	0.67	1.89	124.5 LBS



ARS Series - Two-Way Direct Mount

Model Code Breakdown

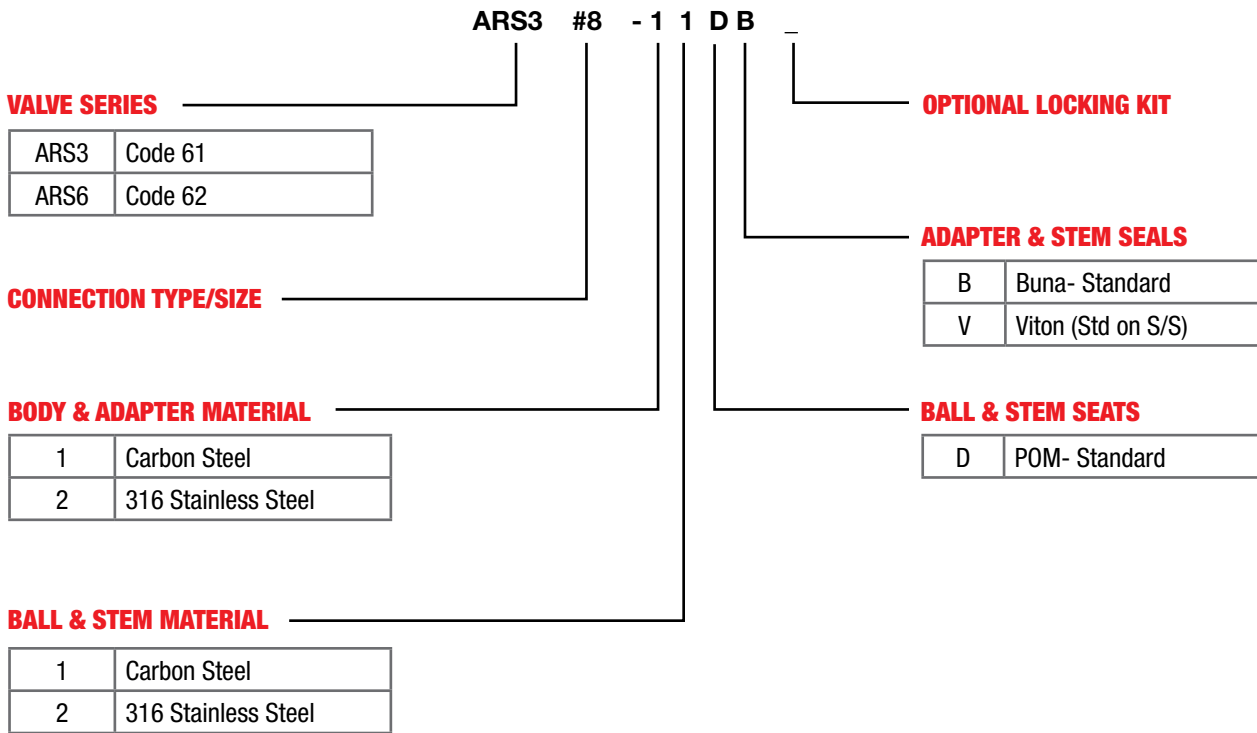

Please consult your system's seal manufacturer for recommendation of seal selection, as Anchor Fluid Power does not accept responsibility for seal selection.

MAXIMUM & MINIMUM WORKING TEMPERATURES FOR SEAL MATERIALS

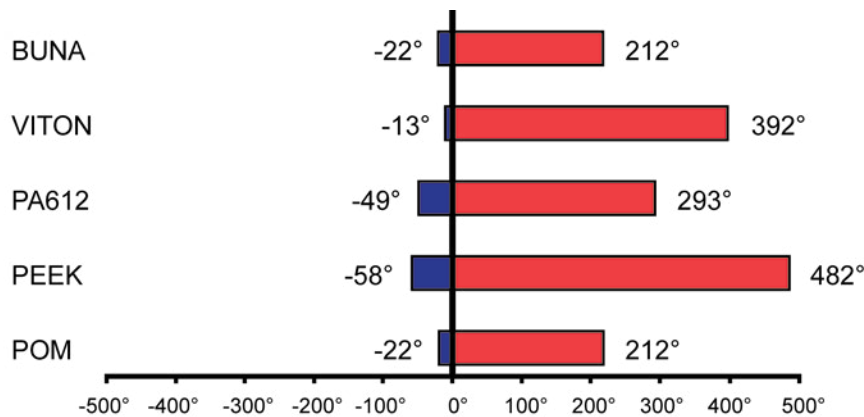

All temperatures are in degrees Fahrenheit.